

X Non-contact thermometry best done with *INFRATHERM* pyrometers



IN 3000

Small and robust infrared sensor

Stationary infrared sensor for non-contact temperature measurement of non-metallic surfaces or painted, coated or anodized metals between 0°C and 500°C

- ◆ 3 temperature ranges
- ◆ 3 different outputs available:
10 mV/°C, Thermocouple K or J
- ◆ Built-in air purge
- ◆ Good value
- ◆ Stainless steel housing with PG11 thread
- ◆ Easy installation and connection
- ◆ Small dimensions
- ◆ Up to 70°C operating temperature without cooling

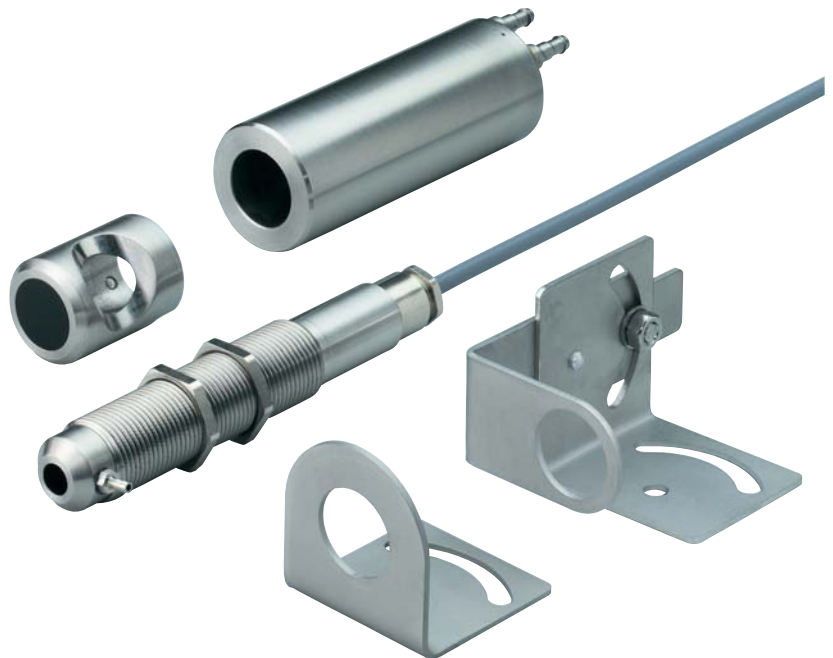

The **IN 3000** is a good value stationary infrared sensor for non-contact temperature measurement of non-metallic surfaces or painted, coated or anodized metals.

The sensor has a fixed emissivity setting of 95% and optical data with a distance ratio (measuring distance / spot size) of 5 : 1. These data in combination with a short response time of 300 ms enable the instrument to be adapted to various measuring tasks.

The solid and robust design of the instrument guarantees high operational safety even in rough industrial environments. With the built-in air purge the lens can be protected from contamination with dust and moisture.

Typical applications:
measurement of:

- plastics
- textile

- asphalt
- rubber
- paint
- glass
- wood
- varnish
- ceramic
- paper
- liquids
- food
- painted metals
- coated metals
- anodized metals

Technical data

Spectral range:	8 ... 14 μm
IR-detector:	Thermopile
Output resistor:	50 Ohm
Analog output:	10 mV/ $^{\circ}\text{C}$ or thermocouple type J or K
Min. load:	50 kOhms
Emissivity:	0.95 fixed
Response time:	300 ms
Repeatability:	1% of measured value or 1 $^{\circ}\text{C}$ *)
Accuracy:	1.5% of temperature range or 2.5 $^{\circ}\text{C}$ *)
Distance ratio:	5 : 1 (measuring distance / spot size)

Connection cable:	1 m length, PVC
Power supply:	24 V DC \pm 25%
Power consumption:	8 mA
Ambient temperature:	0 ... 70 $^{\circ}\text{C}$
Storage temperature:	-30 ... 85 $^{\circ}\text{C}$
Housing:	Stainless steel
Protection class:	IP65 (according DIN 40 050)
Mounting position:	any
Weight:	200 g
CE-label	According to EU directives about electromagnetic immunity

*) the higher value is valid

Dimensions

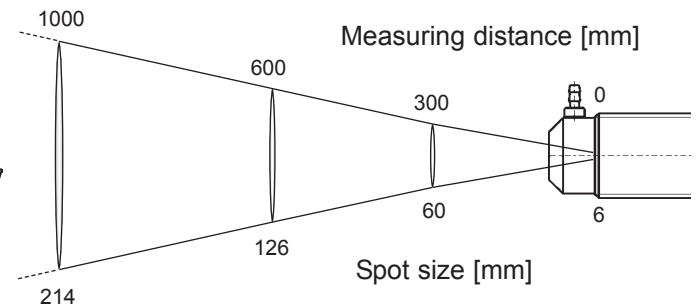
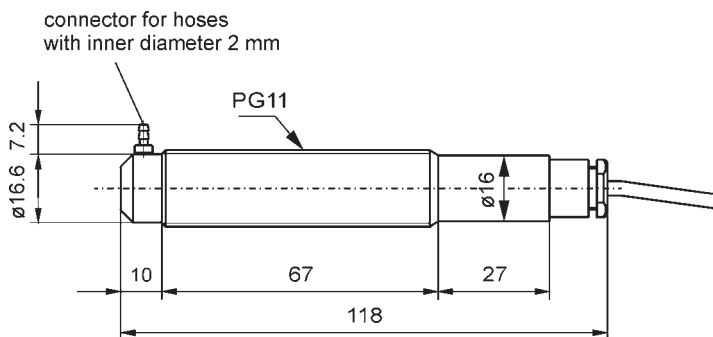

Reference numbers / temperature ranges / measuring outputs

IN 3000 with built-in air purge:

Temperature range:	Output:	10 mV / $^{\circ}\text{C}$	Type J	Type K
0 ... 120 $^{\circ}\text{C}$		3 885 710 (0 ... 1.2 V)	3 885 720	3 885 730
0 ... 300 $^{\circ}\text{C}$		3 885 750 (0 ... 3 V)	3 885 760	3 885 770
100 ... 500 $^{\circ}\text{C}$		3 885 810 (1 ... 5 V)	3 885 820	3 885 830

Accessories:

3 890 600	Power supply 24 V DC
3 837 180	Cooling jacket
3 835 250	90 $^{\circ}$ mirror
3 834 260	Mounting support
3 834 250	Adjustable mounting support



IMPAC Infrared GmbH
Temperature Measurement

Kleyerstr. 90
D-60326 Frankfurt/Main

Phone: +49(0)69/9 73 73-0
Fax: +49(0)69/9 73 73-167

E-Mail: info@impacinfrared.com
Internet: www.impacinfrared.com

Specifications are subject to change without notice.